

DEKTITE SOAKER

The Dektite Soaker reduces and diverts rainwater backup on very low or very high roof pitches or deep ribbed roofing profiles.

- Engineered to eliminate damming
- Withstands temperatures from -50°C to 115°C and up to 150°C intermittently



Code: Black EPDM	Pipe OD (mm)	Base (mm)	Roof Pitch	Pipe (mm)	Roof Pitch
DF602	75 - 160	410 x 360	10° to 60°	N/A	N/A
DF603	114 - 165	485 x 460	10° to 60°	165 - 255	10° to 40°
DF605	250 - 358	708 x 635	10° to 60°	358 - 410	
DF606	380 - 470	1006 x 905	10° to 60°	470 - 610	

For any pitch above 40°, do not cut below the first three sizing ribs on 603, 605 or 606.

The Dektite Soaker is an alternative solution to NZBC E2/1051. Council consent must be sought before installation.

DEKTITE SOAKER (CONT.)

Installation instructions



1 Trim cone to suit pipe size using a sharp pair of tin snips.

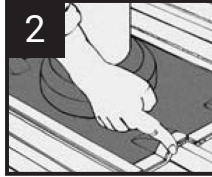

2 Lubricate pipe with water.
Slide the soaker flashing down the pipe and form to suit the roof profile.

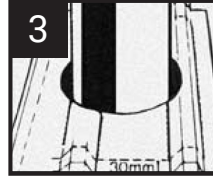

3 Mark the outline of the soaker on the roof then remove.
Mark a lap allowance of 30mm (inside the original mark).
Now determine where soaker sides will finish.

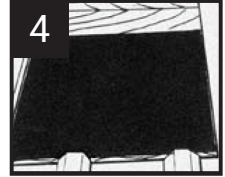

4 Remove roof inside 30mm line.
Trim sharp/uneven edges.
Install timber supports to brace roof where ribs have been removed.
(Pipe not shown above for clarity)



5 Replace soaker in position and apply silicone sealant to the roof while holding up the edge of the flashing.

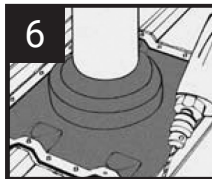

6 Fix using washered self drilling screws or sealed rivets to the middle front and middle back of the soaker and fix progressively towards the edge.

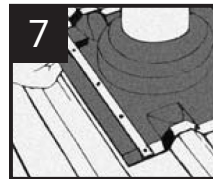

7 Fasten the provided strips.
Trim excess soaker where necessary.
Note:
Side trimming of the soaker should be determined prior to cutting the roof.